

PREPARED FOR:
JASON BERNARD
LAKE GENEVA ARCHITECTS
201 BROAD STREET
LAKE GENEVA, WI 53147

SURVEY ADDRESS:
N2454 FOREST REST LANE

PLAT OF SURVEY

-OF-

LOT 1, BLOCK 1, FOREST REST, A SUBDIVISION LOCATED IN THE
SE 1/4 OF THE SW 1/4 OF SECTION 35, T2N, R17E, AND THE NE
1/4 OF THE NW 1/4 OF SECTION 2, T1N, R17E, TOWN OF LINN,
WALWORTH COUNTY, WISCONSIN

LYNCH & ASSOCIATES
ENGINEERING CONSULTANTS, LLC.
405 SKYLINE DRIVE, SUITE C
LAKE GENEVA, WI 53147
(262) 248-3697

COVENANTS AND RESTRICTIONS SET FORTH IN THE FINAL PLAT OF FOREST REST:

1. LAKE FRONT LOTS SHALL HAVE RESIDENCES OF AT LEAST 1600 SQUARE FEET IN AREA, EXCLUSIVE OF PORCHES AND GARAGES.
2. LOTS 5, 6, 7, 8 AND 9 SHALL HAVE RESIDENCES OF AT LEAST 1400 SQUARE FEET IN AREA, EXCLUSIVE OF PORCHES AND GARAGES.
3. LOTS 10, 11, 12, 13 AND 14 SHALL HAVE RESIDENCES OF AT LEAST 1200 SQUARE FEET IN AREA, EXCLUSIVE OF PORCHES AND GARAGES.
4. SIDE YARDS ON ALL LOTS SHALL BE A MINIMUM OF 15 FEET ON EACH SIDE.
5. SET BACK FROM THE LAKE SHALL BE A MINIMUM OF 75 FEET.
6. NO HOUSE TRAILERS SHALL BE PARKED ON THE LOTS AT ANY TIME.
7. NO RESIDENCE SHALL BE USED FOR LIVING QUARTERS UNTIL THE EXTERIOR IS COMPLETELY FINISHED.

LEGEND

- FOUND 1" IRON PIPE
- FOUND 5/8" IRON ROD
- (XX) RECORDED AS
- ⊗ POWER POLE
- OVERHEAD UTILITIES
- EXISTING FENCE
- ⊙ WELL
- ⊕ SEPTIC VENT
- ⊕ SEPTIC TANK COVER

TAX PARCEL:
ZWIL 00004

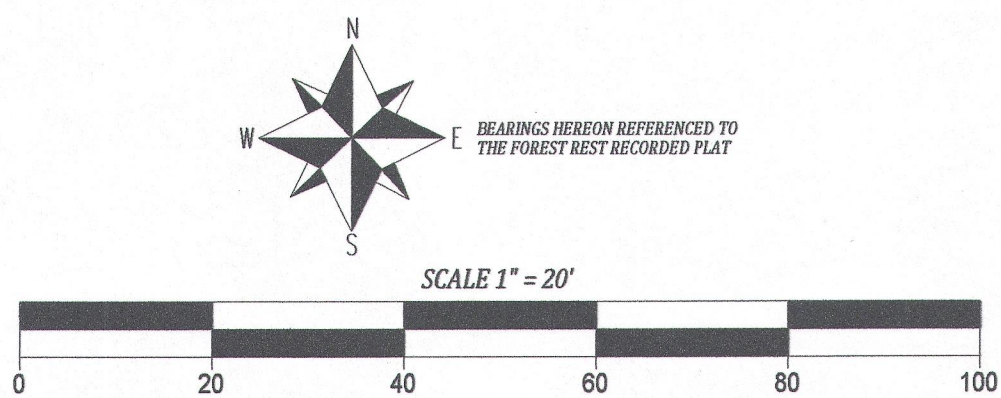

NOTES:

1. THIS PLAT OF SURVEY WAS PREPARED IN COMPLIANCE WITH WISCONSIN ADMINISTRATIVE CODE AE-7 IN CONJUNCTION WITH THE ALTA COMMITMENT FOR TITLE INSURANCE, PREPARED BY CHICAGO TITLE INSURANCE COMPANY, COMMITMENT NO. WA-3775, BEARING AN EFFECTIVE DATE OF JANUARY 2, 2015.

2. NO EASEMENTS OF RECORD WERE IDENTIFIED ON SAID FINAL PLAT OR IN SAID TITLE COMMITMENT.

I have surveyed the above-described property and the above map is a true representation thereof and shows the size and location of the property, its exterior boundaries, the location and dimensions of all structures thereon, fences apparent easements and roadways and visible encroachments, if any.

This survey is made for the exclusive use of the present owners of the property, and also those who purchase, mortgage, or insure the title thereto within one (1) year from date hereof; and as to them I warrant the accuracy of said survey map.

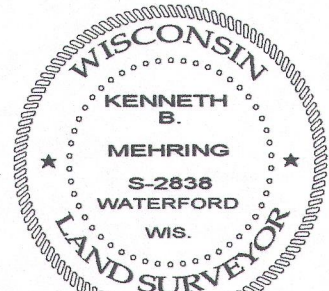

DATED THIS 2nd DAY OF JANUARY, 2015
REVISED THIS 20th DAY OF JANUARY, 2015

KENNETH B. MEHRING S - 2838
Wisconsin Registered Land Surveyor
(original if signed in red)

